



CONVERTCOAT APPLICATORS

Rotating bar technology for streak-free hot melt coatings

Valco Melton's ConvertCoat Applicators with rotating bar technology offer reliable coat weight control and streak-free finish, making them ideal for clear to clear applications, transparent labels, adhesive tapes and flexible packaging.

Key highlights of ConvertCoat applicators include:

- **Guarantee Streak-Free Application.** Servo-driven nozzle bar runs in the same direction as the product to create a uniform, streak-free, coating of adhesive across the full substrate width.
- **Self-Cleaning System.** Rotating bar technology prevents even the smallest contaminants from becoming trapped between the die and the substrate, eliminating the potential risk of damage to the coating surface.
- **Apply low add-on rates.** Coating weight can be controlled as low as 10 gsm with variation across the product within 5%.
- **Achieve an homogeneous adhesive output.** A specially designed flow gallery is engineered inside the coating die for an even adhesive distribution.

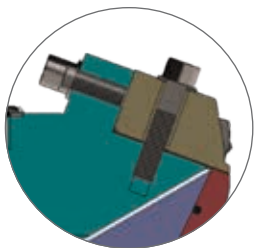

Interchangeable blades allow for width and pattern changes.

Switch from rotating bar to slot die applications.

The applicator includes push&pull adjusters every 50 mm, which allows the rotating bar or the slot die to be fine-tuned for optimal distribution of adhesive output.

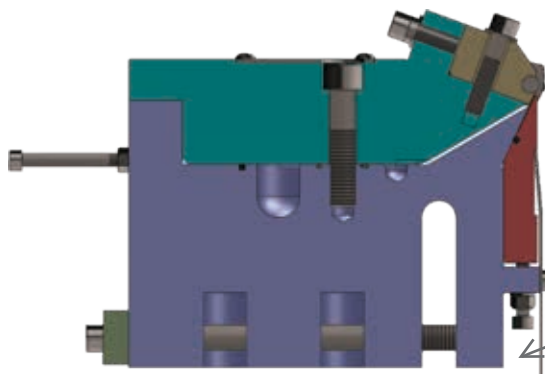
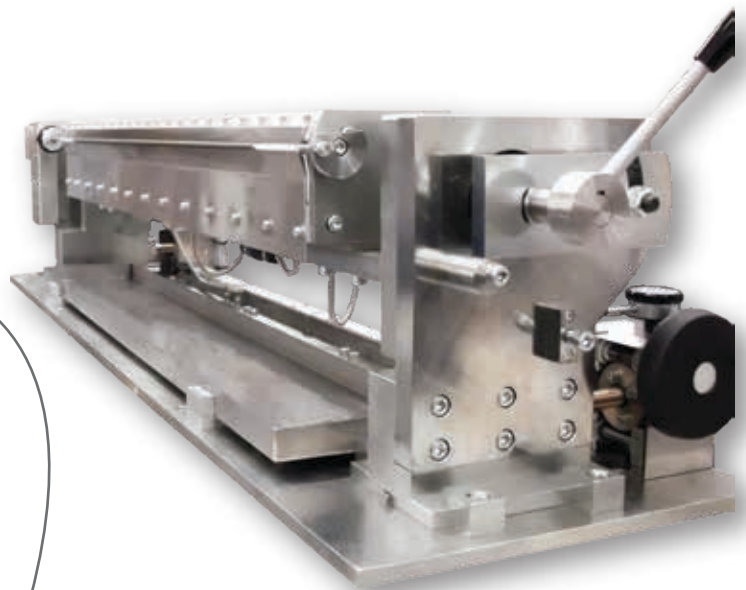

Ensure cleaner applications and a precise adhesive cut with an integrated filter and shut-off valve assembly. Available as an option.

Coat weight adjustments are done inside the applicator and independent of the blade. Pattern changes can be made without re-adjustment.

Flow adjusters every 100 mm on the lower lip allow for a precise tuning of the opening of the die, thus permitting an optimal control of the adhesive output.

Brackets and Upgrade Options

Valco Melton offers a wide range of accessories and upgrade options to adapt to your own specific product requirements.

For easier mounting and installation on to your existing production line, ConvertCoat Applicators may be supplied with an integrated frame assembly.

Benefits:

- **Faster width and pattern changes.** An integrated quick shim change over system allows to rotate the coating head, making the nozzle easily accessible for a faster shim change process.
- **Facilitate maintenance tasks and work changes.** Featuring a pneumatic cylinder powered die mount with 3 set positions: coat, retract, and maintenance.
- **Precise positioning.** Head movement is fine-tuned through a micrometer for precise positioning of the coating die in 2 axis.
- **Guarantee even pressure against coating roller.** Sensors are fitted to the center of the application to monitor the head's fully forward and back position. By incorporating a central cylinder, the pressure of the rotating bar/ slot die against the coating roller is guaranteed to be even throughout the full coating width.
- **Automatically engage / disengage head** through a control system and interface.

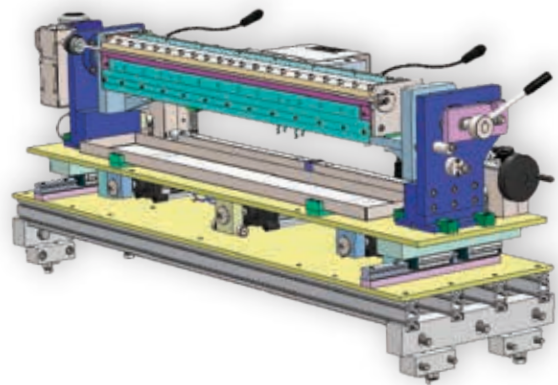

Technical Specifications

ConvertCoat Series Applicators		
Max Coating Width	Up to 1600 mm	
Operating Speed	500 m/min	
Max Operating Temperature	240° C (464° F)	
Max Operating Pressure	100 bar	
Nozzle Options	Continuous	Rotating Bar
Coating Thicknes Range*	20 - 200 gr/sqm	15 - 60 gr/ sqm
Max Electrical Consumption	Body Gun: 2000 W every 400 mm	
Adhesive Input Options	Direct / With Filter / With Shut-off Valve	
Temperature Control	NI-120 / PT-100 / FEKO / NTC	

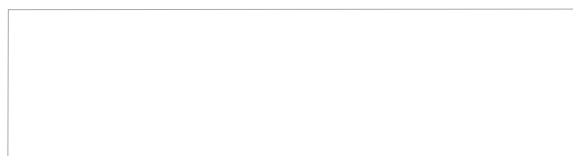

For more information, visit valcomelton.com or contact your local Valco Melton representative.

World Headquarters: USA, Cincinnati, Ohio (Corporate Offices) • Tel:+1.513.874.6550 • Fax: +1.513.874.3612

Europe Headquarters: Spain, Navarra • Tel:+34.948.321.580 • Fax:+34.948.326.584

China: Xiamen, Fujian • Tel:+86.592.591.7854 • Fax:+86.592.591.7834

inquiry@valcomelton.com • Serving over 76 Countries Worldwide • valcomelton.com